

**RESOLUTION NO. 11-32**  
**RESOLUTION CREATING RURAL SPECIAL**  
**IMPROVEMENT MAINTENANCE DISTRICT TO BE KNOWN AS R.S.I.D. #796M**  
**(SOUTH 80<sup>TH</sup> ST WEST - ROAD)**

WHEREAS, the improvements completed on South 80<sup>th</sup> St West necessitate the creation of a rural special improvement maintenance district for the maintenance of South 80<sup>th</sup> St West, from King Ave West to the northern border of West Meadows Subdivision , as shown in Exhibit A (map) in Yellowstone County, Montana; and,

WHEREAS, the boundaries of the district are described in Exhibit B; and,

WHEREAS, all of the costs of the district shall be assessed equally on a per lot method for existing and future lots (Exhibit D); and,

WHEREAS, the cost estimate as shown in Exhibit C is only an estimate of annual costs and is subject to cost fluctuations due to maintenance utilization levels and changes in material and labor costs of performing necessary maintenance; and,

WHEREAS, the property assessment amount is subject to adjustment and will be established annually by the Board of County Commissioners; and,

WHEREAS, the district shall be considered to exist perpetually unless included within another district providing the same services or assumed by a municipality.

NOW, THEREFORE, BE IT RESOLVED by the Board of County Commissioners of Yellowstone County, Montana, deeming the public interest or convenience require the creation of the rural special improvement maintenance district, intends to create the following described Rural Special Improvement Maintenance District:

1. **NUMBER OF DISTRICT.** The Rural Special Improvement Maintenance District shall be designated as District No. 796M.
2. **DESCRIPTION OF DISTRICT.** The exterior boundaries of the District are shown in Exhibit A and described in Exhibit B.
3. **DESCRIPTION OF IMPROVEMENTS, DESCRIPTION OF MAINTENANCE, METHOD OF ASSESSMENT AND ESTIMATED COSTS.** Assessments collected on behalf of this district shall be used for the maintenance of South 80<sup>th</sup> Street West, from King Ave. West to the northern border of West Meadows Subdivision, as estimated in Exhibit C. All of the costs of the district shall be assessed equally on a per lot method for existing and future lots (Exhibit D).
4. **DURATION.** The district shall be deemed to be perpetual in nature unless absorbed and replaced by another district or municipality.

5. The Commissioners desire that an Ad Hoc Committee be appointed to make recommendations to the Commissioners with regard to the need for assessments to be made for maintenance, the amount of assessments, and how the assessments should be spent. The Commissioners request a list of some individuals who are willing to serve on the Ad Hoc Committee

PASSED AND ADOPTED by the Board of County Commissioners of Yellowstone County, Montana, this 26<sup>th</sup> day of April, 2011.

BOARD OF COUNTY COMMISSIONERS  
YELLOWSTONE COUNTY, MONTANA

  
John Ostlund, Chairman

  
James E. Reno, Member

  
Bill Kennedy, Member

(SEAL)  
ATTEST:

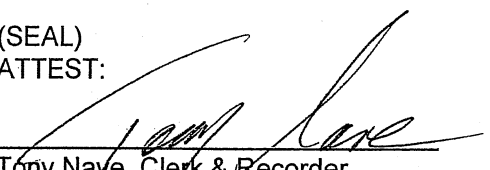
  
Tony Nave, Clerk & Recorder  
Yellowstone County, Montana

# EXHIBIT A

Proposed 796M  
for street maintenance of  
South 80th Street West

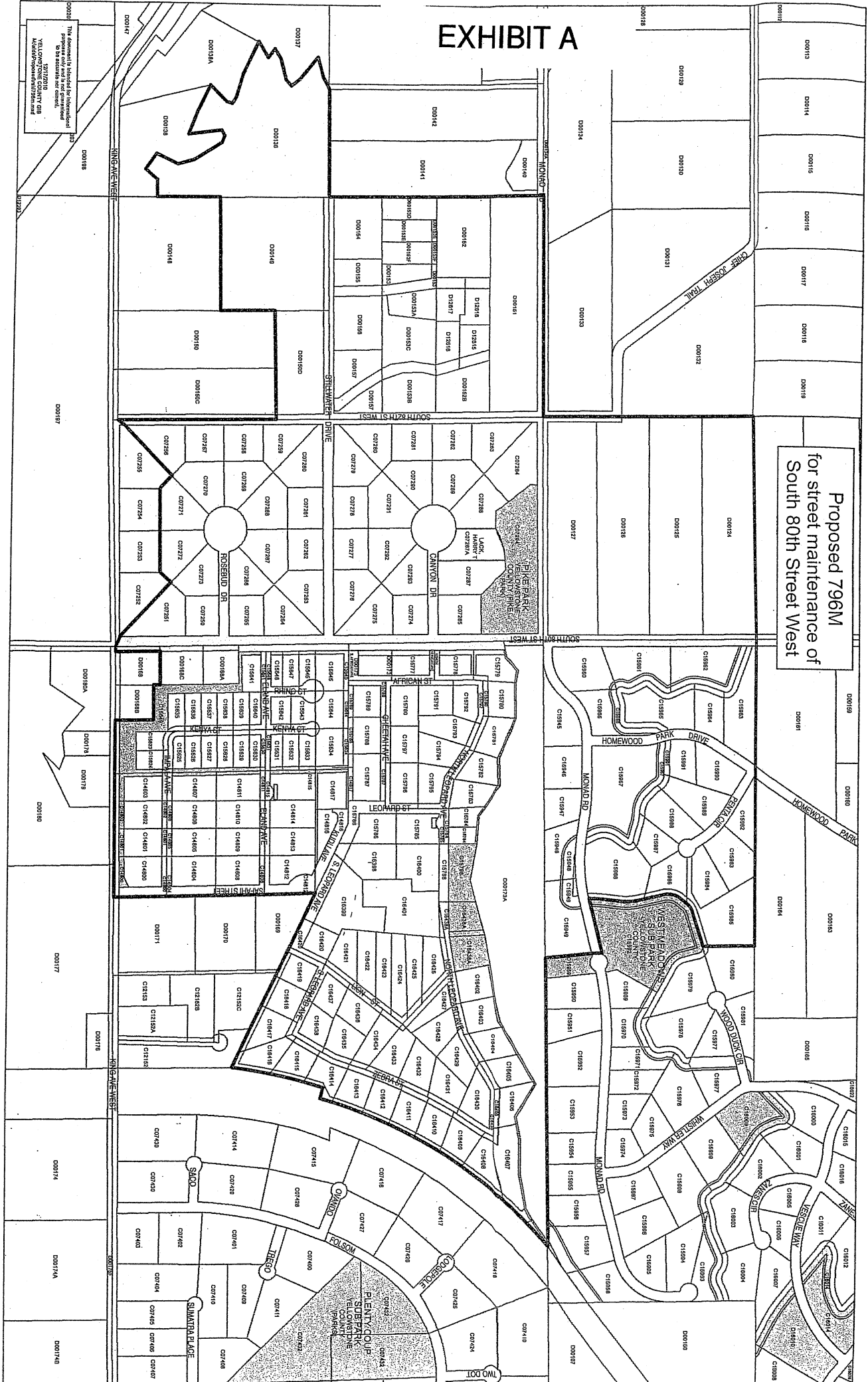

This document is intended for information purposes only and is not guaranteed to be accurate or complete. YELLOWKNIFE COUNTY GIS Information Services

EXHIBIT B  
PROPERTY LEGAL DESCRIPTIONS

TAX_ID	BLK_NUM	LOT_NUM	CERT_SUR'SUBD	TR_NUM
1	C07250	1	1	PIKE SUB
2	C07251	1	2	PIKE SUB
3	C07256	1	7	PIKE SUB
4	C07257	1	8	PIKE SUB
5	C07258	1	9	PIKE SUB
6	C07259	1	10	PIKE SUB
7	C07260	1	11	PIKE SUB
8	C07261	1	12	PIKE SUB
9	C07262	1	13	PIKE SUB
10	C07263	1	14	PIKE SUB
11	C07264	1	15	PIKE SUB
12	C07265	1	16	PIKE SUB
13	C07266	1	17	PIKE SUB
14	C07267	1	18	PIKE SUB
15	C07268	1	19	PIKE SUB
16	C07269	1	20	PIKE SUB
17	C07270	1	21	PIKE SUB
18	C07271	1	22	PIKE SUB
19	C07272	1	23	PIKE SUB
20	C07273	1	24	PIKE SUB
21	C07274	2	1	PIKE SUB
22	C07275	2	2	PIKE SUB
23	C07276	2	3	PIKE SUB
24	C07277	2	4	PIKE SUB
25	C07278	2	5	PIKE SUB
26	C07279	2	6	PIKE SUB
27	C07280	2	7	PIKE SUB
28	C07281	2	8	PIKE SUB
29	C07282	2	9	PIKE SUB
30	C07283	2	10	PIKE SUB
31	C07284	2	11	PIKE SUB
32	C07285	2	12	PIKE SUB
33	C07287	2	13A	PIKE SUB
34	C07287A	2	14A	PIKE SUB
35	C07288	2	15	PIKE SUB
36	C07289	2	16	PIKE SUB
37	C07290	2	17	PIKE SUB
38	C07291	2	18	PIKE SUB
39	C07292	2	19	PIKE SUB
40	C07293	2	20	PIKE SUB
41	C07294	2	Park	PIKE SUB
42	C14800	1	1-A	KING AVE ESTATES NO.1 SUB 3RD AMD
43	C14801	1	1-B	KING AVE ESTATES NO.1 SUB 3RD AMD
44	C14802	1	1-C	KING AVE ESTATES NO.1 SUB 3RD AMD
45	C14803	1	1-D	KING AVE ESTATES NO.1 SUB 3RD AMD
46	C14804	1	2-A	KING AVE ESTATES NO.1 SUB 3RD AMD
47	C14805	1	2-B	KING AVE ESTATES NO.1 SUB 3RD AMD
48	C14806	1	2-C	KING AVE ESTATES NO.1 SUB 3RD AMD
49	C14807	1	2-D	KING AVE ESTATES NO.1 SUB 3RD AMD
50	C14808	1	3-A	KING AVE ESTATES NO.1 SUB 3RD AMD
51	C14809	1	3-B	KING AVE ESTATES NO.1 SUB 3RD AMD
52	C14810	1	3-C	KING AVE ESTATES NO.1 SUB 3RD AMD
53	C14811	1	3-D	KING AVE ESTATES NO.1 SUB 3RD AMD
54	C14812	1	4-A	KING AVE ESTATES NO.1 SUB 3RD AMD
55	C14813	1	4-B	KING AVE ESTATES NO.1 SUB 3RD AMD
56	C14814	1	4-C	KING AVE ESTATES NO.1 SUB 3RD AMD
57	C14815	1	4-D	KING AVE ESTATES NO.1 SUB 3RD AMD
58	C14816	1	1	BOTH STREET ESTATES SUB 2ND FIL
59	C14817	1	5B1	KING AVE ESTATES NO.1 SUB CORR 4TH AMD
60	C15623	1	1	KING AVE ESTATES NO.2 SUB
61	C15624	1	2	KING AVE ESTATES NO.2 SUB
62	C15625	1	3	KING AVE ESTATES NO.2 SUB
63	C15626	1	4	KING AVE ESTATES NO.2 SUB
64	C15627	1	5	KING AVE ESTATES NO.2 SUB
65	C15628	1	6	KING AVE ESTATES NO.2 SUB
66	C15629	1	7	KING AVE ESTATES NO.2 SUB
67	C15630	1	8	KING AVE ESTATES NO.2 SUB
68	C15631	1	9	KING AVE ESTATES NO.2 SUB CORR
69	C15632	1	10	KING AVE ESTATES NO.2 SUB CORR
70	C15633	1	11	KING AVE ESTATES NO.2 SUB CORR
71	C15634	1	12	KING AVE ESTATES NO.2 SUB CORR
72	C15635	2	1	KING AVE ESTATES NO.2 SUB

EXHIBIT B  
PROPERTY LEGAL DESCRIPTIONS

TAX_ID	BLK_NUM	LOT_NUM	CERT_SUR' SUBD	TR_NUM
73	C15636	2	2	KING AVE ESTATES NO.2 SUB
74	C15637	2	3	KING AVE ESTATES NO.2 SUB
75	C15638	2	4	KING AVE ESTATES NO.2 SUB
76	C15639	2	5	KING AVE ESTATES NO.2 SUB
77	C15640	2	6	KING AVE ESTATES NO.2 SUB
78	C15641	2	7	KING AVE ESTATES NO.2 SUB
79	C15642	3	1	KING AVE ESTATES NO.2 SUB
80	C15643	3	2	KING AVE ESTATES NO.2 SUB
81	C15644	3	3	KING AVE ESTATES NO.2 SUB
82	C15645	3	4	KING AVE ESTATES NO.2 SUB
83	C15646	3	5	KING AVE ESTATES NO.2 SUB
84	C15647	3	6	KING AVE ESTATES NO.2 SUB
85	C15648	3	7	KING AVE ESTATES NO.2 SUB
86	C15649		Park	KING AVE ESTATES NO.2 SUB
87	C15777	1	2	80TH STREET ESTATES SUB 1ST FIL
88	C15778	1	3	80TH STREET ESTATES SUB 1ST FIL
89	C15779	1	4	80TH STREET ESTATES SUB 1ST FIL
90	C15780	1	5	80TH STREET ESTATES SUB 1ST FIL
91	C15781	1	6	80TH STREET ESTATES SUB 1ST FIL
92	C15782	1	7	80TH STREET ESTATES SUB 1ST FIL
93	C15783	1	8	80TH STREET ESTATES SUB 1ST FIL
94	C15784	1	9	80TH STREET ESTATES SUB 1ST FIL
95	C15785	1	10	80TH STREET ESTATES SUB 1ST FIL
96	C15786	1	11	80TH STREET ESTATES SUB 1ST FIL
97	C15787	1	12	80TH STREET ESTATES SUB 1ST FIL
98	C15788	1	13	80TH STREET ESTATES SUB 1ST FIL
99	C15789	1	14	80TH STREET ESTATES SUB 1ST FIL
100	C15790	1	15	80TH STREET ESTATES SUB 1ST FIL
101	C15791	1	16	80TH STREET ESTATES SUB 1ST FIL
102	C15792	1	17	80TH STREET ESTATES SUB 1ST FIL
103	C15793	1	18	80TH STREET ESTATES SUB 1ST FIL
104	C15794	1	19	80TH STREET ESTATES SUB 1ST FIL
105	C15795	1	20	80TH STREET ESTATES SUB 1ST FIL
106	C15796	1	21	80TH STREET ESTATES SUB 1ST FIL
107	C15797	1	22	80TH STREET ESTATES SUB 1ST FIL
108	C15798	1	Park	80TH STREET ESTATES SUB 1ST FIL
109	C15945	1	1	WEST MEADOWS SUB
110	C15946	1	2	WEST MEADOWS SUB
111	C15947	1	3	WEST MEADOWS SUB
112	C15948	1	4	WEST MEADOWS SUB
113	C15949	1	5	WEST MEADOWS SUB
114	C15960	2	1	WEST MEADOWS SUB
115	C15961	2	2	WEST MEADOWS SUB
116	C15962	2	3	WEST MEADOWS SUB
117	C15963	2	4	WEST MEADOWS SUB
118	C15964	2	5	WEST MEADOWS SUB
119	C15965	2	6	WEST MEADOWS SUB
120	C15966	2	7	WEST MEADOWS SUB
121	C15967	3	1	WEST MEADOWS SUB
122	C15968	3	2	WEST MEADOWS SUB
123	C15982	3	16	WEST MEADOWS SUB
124	C15983	3	17	WEST MEADOWS SUB
125	C15984	3	18	WEST MEADOWS SUB
126	C15985	3	19	WEST MEADOWS SUB
127	C15986	3	20	WEST MEADOWS SUB
128	C15987	3	21	WEST MEADOWS SUB
129	C15988	3	22	WEST MEADOWS SUB
130	C15989	3	23	WEST MEADOWS SUB
131	C15990	3	24	WEST MEADOWS SUB
132	C15991	3	25	WEST MEADOWS SUB
133	C16398	1	2A	80TH STREET ESTATES SUB 2ND FIL
134	C16399	1	3A	80TH STREET ESTATES SUB 2ND FIL
135	C16400	1	4A	80TH STREET ESTATES SUB 2ND FIL
136	C16401	1	5A	80TH STREET ESTATES SUB 2ND FIL
137	C16402	1	6	80TH STREET ESTATES SUB 2ND FIL
138	C16403	1	7	80TH STREET ESTATES SUB 2ND FIL
139	C16404	1	8	80TH STREET ESTATES SUB 2ND FIL
140	C16405	1	9	80TH STREET ESTATES SUB 2ND FIL
141	C16406	1	10	80TH STREET ESTATES SUB 2ND FIL
142	C16407	1	11	80TH STREET ESTATES SUB 2ND FIL
143	C16408	1	12	80TH STREET ESTATES SUB 2ND FIL
144	C16409	1	13	80TH STREET ESTATES SUB 2ND FIL

**EXHIBIT B  
PROPERTY LEGAL DESCRIPTIONS**

TAX_ID	BLK_NUM	LOT_NUM	CERT_SUR	SUBD	TR_NUM
145	C16410	1	14	80TH STREET ESTATES SUB 2ND FIL	
146	C16411	1	15	80TH STREET ESTATES SUB 2ND FIL	
147	C16412	1	16	80TH STREET ESTATES SUB 2ND FIL	
148	C16413	1	17	80TH STREET ESTATES SUB 2ND FIL	
149	C16414	1	18	80TH STREET ESTATES SUB 2ND FIL	
150	C16415	1	19	80TH STREET ESTATES SUB 2ND FIL	
151	C16416	1	20	80TH STREET ESTATES SUB 2ND FIL	
152	C16417	1	21	80TH STREET ESTATES SUB 2ND FIL	
153	C16418	1	22	80TH STREET ESTATES SUB 2ND FIL	
154	C16419	1	23	80TH STREET ESTATES SUB 2ND FIL	
155	C16420	1	24	80TH STREET ESTATES SUB 2ND FIL	
156	C16421	1	25	80TH STREET ESTATES SUB 2ND FIL	
157	C16422	1	26	80TH STREET ESTATES SUB 2ND FIL	
158	C16423	1	27	80TH STREET ESTATES SUB 2ND FIL	
159	C16424	1	28	80TH STREET ESTATES SUB 2ND FIL	
160	C16425	1	29	80TH STREET ESTATES SUB 2ND FIL	
161	C16426	1	30	80TH STREET ESTATES SUB 2ND FIL	
162	C16427	1	31	80TH STREET ESTATES SUB 2ND FIL	
163	C16428	1	32	80TH STREET ESTATES SUB 2ND FIL	
164	C16429	1	33	80TH STREET ESTATES SUB 2ND FIL	
165	C16430	1	34	80TH STREET ESTATES SUB 2ND FIL	
166	C16431	1	35	80TH STREET ESTATES SUB 2ND FIL	
167	C16432	1	36	80TH STREET ESTATES SUB 2ND FIL	
168	C16433	1	37	80TH STREET ESTATES SUB 2ND FIL	
169	C16434	1	38	80TH STREET ESTATES SUB 2ND FIL	
170	C16435	1	39	80TH STREET ESTATES SUB 2ND FIL	
171	C16436	1	40	80TH STREET ESTATES SUB 2ND FIL	
172	C16437	1	41	80TH STREET ESTATES SUB 2ND FIL	
173	C16438	1	42	80TH STREET ESTATES SUB 2ND FIL	
174	C16438A	1	Park	80TH STREET ESTATES SUB 2ND FIL	
175	D00124		CS 1425		TR 21
176	D00125		CS 1425		TR 22
177	D00126		CS 1425		TR 23
178	D00127		CS 1425		TR 24
179	D00136		CS 1373 AM		TR 1
180	D00149		CS 1393 AM		TR 2
181	D00150D		CS 3173		TR 2
182	D00151		CS 1397		TR 1
183	D00152		CS 1397		TR 2A
184	D00152B		CS 1397		TR 2C
185	D00153		CS 1397		TR 3A4
186	D00153A		CS 1397AM TRS3B1&3B2		TR 3B1A
187	D00153B		CS 1397		TR 3C
188	D00153C		CS 1397AM TRS3B1&3B2		TR 3B2A
189	D00153D		CS 1397		TR 3A1
190	D00153E		CS 1397		TR 3A2
191	D00153F		CS 1397		TR 3A3
192	D00154		CS 1397		TR 4A1A
193	D00155		CS 1397		TR 4A1B
194	D00156		CS 1397		TR 4B1
195	D00157		CS 1397		TR 4C1
196	D00168A		CS 976 AM		TR 1A2
197	D00168C		CS 3183		TR 2A
198	D00173	1	1	80TH STREET ESTATES SUB 1ST FIL	
199	D00173A		CS 3236		TR 2A
200	D12615		CS 3064		TR 1
201	D12616		CS 3064		TR 2
202	D12617		CS 3064		TR 3
203	D12618		CS 3064		TR 4
203					
-1	C07294	Park			
-1	C15649	Park			
-1	C15798	Park			
-1	C16438A	Park			

199 Properties to Assess

**EXHIBIT C**  
**ESTIMATED ANNUAL MAINTENANCE COST**

**FALL MAINTENANCE:**

ACTIVITY	ESTIMATED COST
SNOW REMOVAL	\$ 250
	\$

**WINTER MAINTENANCE:**

ACTIVITY	ESTIMATED COST
SNOW REMOVAL	\$ 250
	\$

**SPRING MAINTENANCE:**

ACTIVITY	ESTIMATED COST
SNOW REMOVAL	\$ 250
	\$

**SUMMER MAINTENANCE:**

ACTIVITY	ESTIMATED COST
WEED CONTROL	\$ 108
CHIP SEAL	\$ 7,500

**TOTAL ESTIMATED ANNUAL MAINTENANCE COST: \$8,358**

199 Parcels @ \$42 each

**EXHIBIT D**  
**METHOD OF ASSESSMENT**

**CHOOSE A METHOD OF ASSESSMENT:**

Square Footage

Equal Amount

Front Footage

Other (Describe)

---

---

---

---

---

---

---